

CSW 103: Entryway Table

Material List:

- a 8/4 board, 8" x 72" (see figure 1)
- a 4/4 board, 6" x 94" (see figure 2)
- a 5/4 or 6/4 board, either 6" x 60" or 8" x 40" (see figure 3)

figure 1: 8/4 board for legs & rails

This board will be used for making table legs and rails, and will be cut up like the example below:

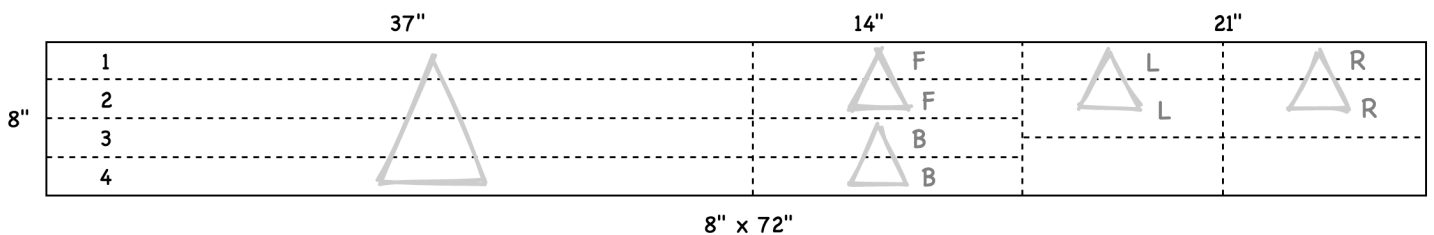

Figure 2: Drawer Front, Back, and Side panels

This board will be cut up to provide the drawer panels, like so:

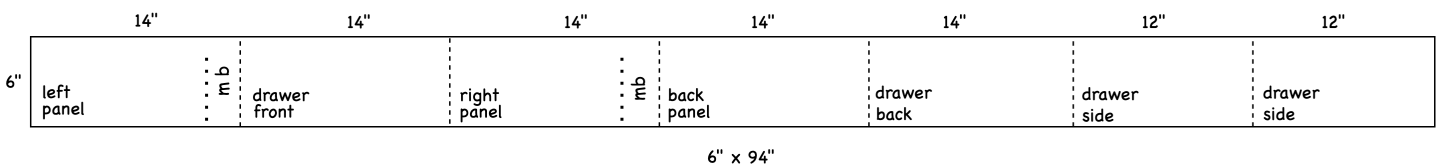
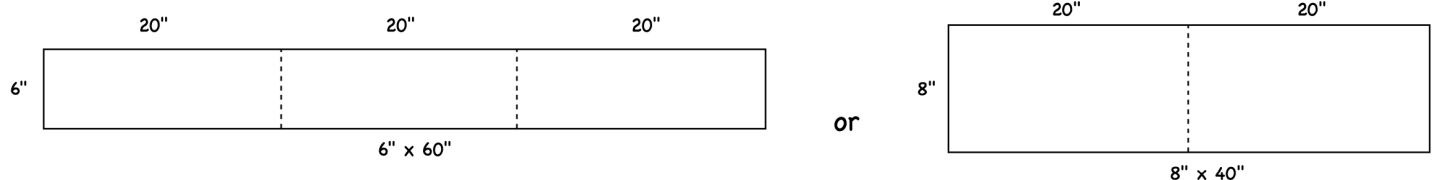

Figure 3: Tabletop

The board dimension is determined on how thick you like the top to be (choose either 5/4 or 6/4 thickness), and whether you prefer the look of a two or three board table (6" x 60" for three, or 8" x 40" for two):



Chicago School of Woodworking, LLC

5680 N. Northwest Hwy. Chicago, IL 60646
(773) 275-1170

Cut List:

These are the final dimensions we will cut to, in class. This page is your in-class reference.

#	pieces	name	thickness	width	length
1	4	Legs	1 $\frac{3}{4}$ "	1 $\frac{3}{4}$ "	36"
2	2	top side frame rail	1 $\frac{1}{2}$ "	1 $\frac{3}{4}$ "	10"
3	2	lower side frame rail	1 $\frac{1}{2}$ "	2 $\frac{1}{2}$ "	10"
4	4	front & back frame rail	1 $\frac{1}{2}$ "	1 $\frac{3}{4}$ "	13"
5	2	side panel	$\frac{3}{4}$ "	5-11/16"	10-7/16"
6	1	back panel	$\frac{3}{4}$ "	5-11/16"	13-7/16"
7	1	top	$\frac{7}{8}$ "	15"	18"
8	6	mounting blocks	$\frac{3}{4}$ "	1 $\frac{1}{2}$ "	2 $\frac{1}{2}$ "
9	2	drawer sides	$\frac{3}{4}$ "	5 $\frac{1}{4}$ "	11 $\frac{1}{4}$ "
10	1	drawer back	$\frac{3}{4}$ "	5 $\frac{1}{4}$ "	13"
11	1	drawer front	$\frac{3}{4}$ "	5 $\frac{1}{4}$ "	13"
12	1	drawer bottom	$\frac{1}{4}$ "	11"	12"

Required tools:

- Hearing and eye protection
- Fractional Dial Calipers
- Chalk, and pencil

Refer our website for links and suggestions for these required tools:

<https://chicagowoodworking.com/woodworking-resources/>